

101 STREET S.W.

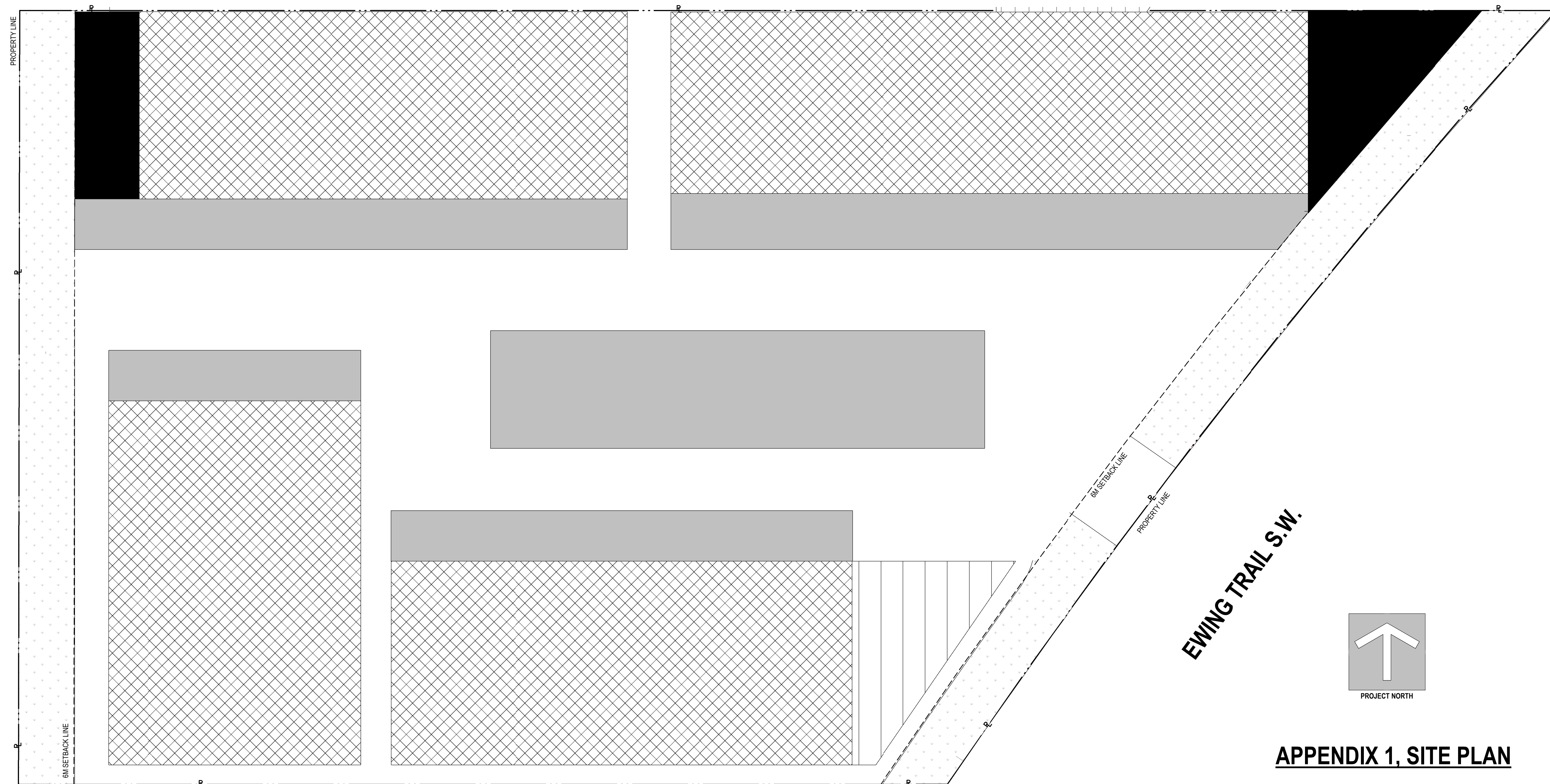

EWING TRAIL S.W.

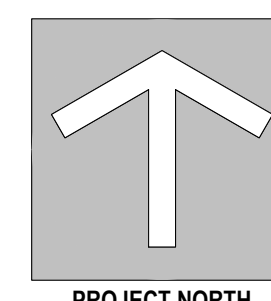

APPENDIX 1, SITE PLAN

LEGEND

- PROPERTY LINE**
- 6M SETBACK LINE**
- GENERAL BUILDING LOCATIONS**
- PARKING LOCATIONS**
- OUTDOOR PATIO AREA**
- LANDSCAPED SETBACKS**
- OUTDOOR AREAS (PATIO / PLAYSPACE)**

This drawing has been prepared solely for the use of ENTITY DEVELOPMENTS INC. and there are no representations of any kind made by LARRY PODHORA / ARCHITECT to any party with whom LARRY PODHORA / ARCHITECT has not entered into a contract. This drawing shall not be used for construction purposes until it is issued for the purpose.

| NO. | DATE | Y/M/D | DESCRIPTION |
|----------------------|------|-------|-------------|
| ISSUES AND REVISIONS | | | |
| SEAL | | | |

larry podhora / architect
1952 BRACKMAN WAY, NORTH SAANICH, B.C. V8L 0C2

PROJECT NAME
EWING TRAIL COMMERCIAL

PROJECT ADDRESS
**3408 - 3478 EWING TRAIL SW
EDMONTON, AB T6X 1A1**

DRAWING TITLE
**SITE PLAN - REZONING
APPENDIX 1**

SCALE As indicated

DRAWN

REVIEWED

PROJECT NO. 180900

DRAWING NO.

A1

PRELIMINARY - NOT FOR CONSTRUCTION